



[www.eMPR.com](http://www.eMPR.com)

## PRESCRIBING ALERT<sup>®</sup>

Dear Healthcare Professional,

At MPR we strive to bring you important drug information in a concise and timely manner. In keeping with this goal, we are pleased to provide you with this PRESCRIBING ALERT with detailed information on [TUDORZA<sup>®</sup> PRESSAIR<sup>®</sup> \(aclidinium bromide inhalation powder\) 400 mcg](#), manufactured by [Forest Pharmaceuticals, Inc.](#)

TUDORZA PRESSAIR is an anticholinergic indicated for the long-term maintenance treatment of bronchospasm associated with chronic obstructive pulmonary disease (COPD), including chronic bronchitis and emphysema. In clinical studies, TUDORZA showed statistically significant improvements in morning predose lung function (forced expiratory volume in one second [FEV<sub>1</sub>]) at 12 weeks (primary endpoint) or 24 weeks vs placebo.<sup>1-4</sup> Improvements in lung function were maintained for 12 hours after the first dose and were consistent over 12 or 24 weeks.<sup>1</sup>

TUDORZA is administered twice daily using a preloaded, multiple-dose, dry powder inhaler called PRESSAIR.<sup>1</sup> Features of the PRESSAIR inhaler include a dose indicator that shows approximately how many doses remain in the inhaler, and a colored control window that provides confirmation of successful inhalation. Taking a dose from the PRESSAIR inhaler requires the patient to Press, Release, and Inhale.<sup>1</sup> For a complete description of how to use the TUDORZA PRESSAIR inhaler, see the step-by-step Instructions for Use within the full Prescribing Information.

### IMPORTANT SAFETY INFORMATION

- TUDORZA PRESSAIR is not indicated for the initial treatment of acute episodes of bronchospasm (ie, rescue therapy).
- Inhaled medicines, including TUDORZA, may cause paradoxical bronchospasm. In addition, immediate hypersensitivity reactions may occur after administration of TUDORZA. If either of these occurs, treatment with TUDORZA should be stopped and other treatments considered.
- TUDORZA should be used with caution in patients with narrow-angle glaucoma or urinary retention. Instruct patients to consult a physician immediately should any signs or symptoms of narrow-angle glaucoma or prostatic hyperplasia or bladder-neck obstruction develop.
- Patients with a history of hypersensitivity reactions to atropine should be closely monitored for similar hypersensitivity reactions to TUDORZA. Use with caution in patients with severe hypersensitivity to milk proteins.
- The most common adverse reactions ( $\geq 3\%$  incidence and greater than placebo) were headache (6.6% vs 5.0%), nasopharyngitis (5.5% vs 3.9%), and cough (3.0% vs 2.2%), for TUDORZA vs placebo, respectively.

*Please [click here](#) to see the full **Prescribing Information**.*

More information regarding the use of TUDORZA is available at [eMPR.com](http://eMPR.com).

Sincerely,

Madonna Krawczyk, PharmD  
Director of Clinical Communications  
MPR Custom Programs

### REFERENCES

**1.** TUDORZA PRESSAIR (aclidinium bromide inhalation powder) Prescribing Information. Forest Pharmaceuticals, Inc. St. Louis, MO. **2.** Data on file. Forest Laboratories, Inc. **3.** Kerwin EM, D'Urzo AD, Gelb AF, et al, on behalf of the ACCORD I study investigators. Efficacy and safety of a 12-week treatment with twice-daily aclidinium bromide in COPD patients (ACCORD COPD I). *COPD*. 2012;9:90-101. **4.** Jones PW, Singh D, Bateman ED, et al. Efficacy and safety of twice-daily aclidinium bromide in COPD patients: the ATTAIN study. *Eur Respir J*. 2012;40(4):830-836.





# TUDORZA® PRESSAIR®

(aclidinium bromide inhalation powder) 400 mcg

**Rx**

**Company:** Forest Pharmaceuticals, Inc.  
**Pharmacological Class:** Long-acting anticholinergic.  
**Active Ingredient:** Acclidinium bromide.  
**Indication:** Long-term maintenance treatment of bronchospasm associated with chronic obstructive pulmonary disease (COPD), including chronic bronchitis and emphysema.  
**Mechanism of Action:** Acclidinium bromide is a long-acting antimuscarinic agent, which is often referred to as an anticholinergic. It has similar affinity to the subtypes of muscarinic receptors M<sub>1</sub> to M<sub>5</sub>. In the airways, it exhibits pharmacological effects through inhibition of the M<sub>3</sub> receptor at the smooth muscle leading to bronchodilation. The bronchodilation following inhalation of acclidinium bromide is predominantly a site-specific effect.  
**Dosing:** 1 inhalation (400 mcg) twice daily.  
**Specific Populations:** Pregnancy: Cat. C. Labor & delivery: Use if

benefit justifies the risk. Nursing mothers: Use caution. Excretion in human milk is probable. Pediatrics: The safety and effectiveness of TUDORZA PRESSAIR in pediatric patients have not been established. COPD does not normally occur in children.  
**Warnings & Precautions:** Not for acute use. Paradoxical bronchospasm. Worsening of narrow-angle glaucoma. Worsening of urinary retention. Immediate hypersensitivity reactions: use with caution in patients with severe hypersensitivity to milk proteins. (See Important Safety Information below and throughout.)  
**Drug Interaction:** Avoid coadministration with other anticholinergics.  
**Adverse Reactions:** Most common (≥3% incidence and greater than placebo): headache (6.6% vs 5.0%), nasopharyngitis (5.5% vs 3.9%), and cough (3.0% vs 2.2%).  
**How Supplied:** Dry powder inhaler—60 doses.

-  TUDORZA® is a long-acting anticholinergic indicated for the long-term maintenance treatment of bronchospasm associated with chronic obstructive pulmonary disease (COPD), including chronic bronchitis and emphysema<sup>1</sup>
-  TUDORZA provides statistically significant improvements in bronchodilation that are consistent over time<sup>1</sup>
-  In a 12-week placebo-controlled study (ACCORD COPD I) TUDORZA provided statistically significant improvements in morning trough (predose) lung function at 12 weeks<sup>2,3</sup> (See results for 2 additional pivotal studies on the next page)

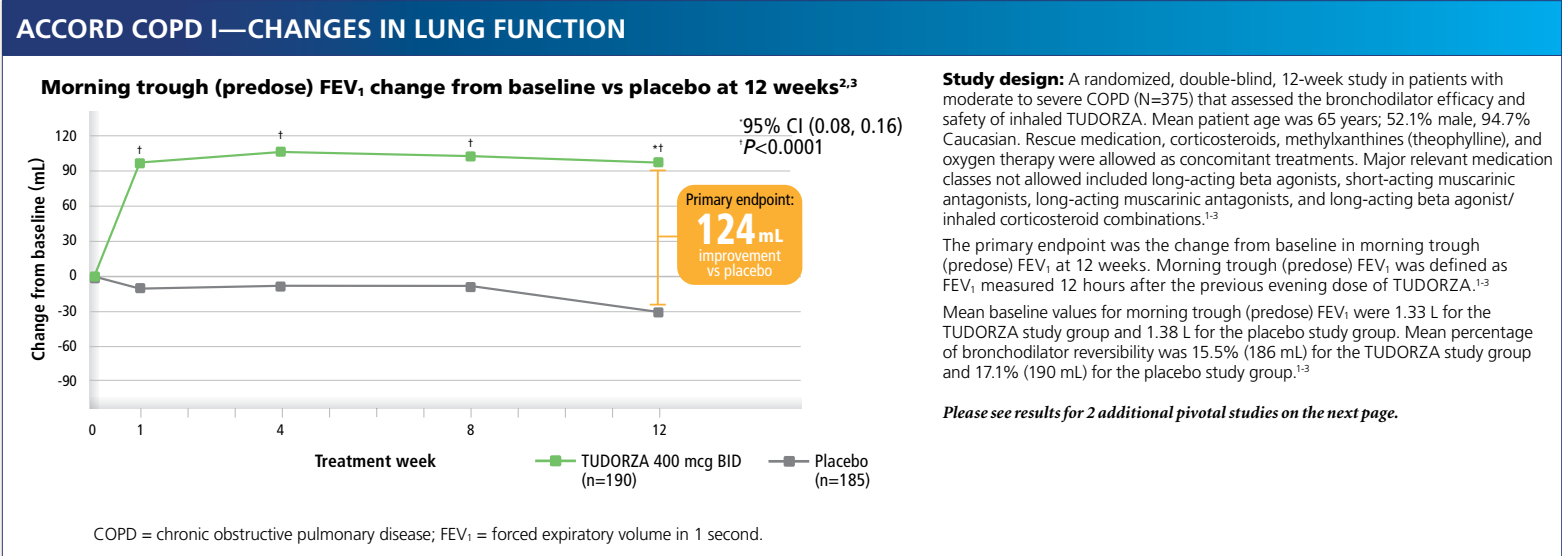

## Important Safety Information

- TUDORZA PRESSAIR is not indicated for the initial treatment of acute episodes of bronchospasm (ie, rescue therapy).
- Inhaled medicines, including TUDORZA, may cause paradoxical bronchospasm. In addition, immediate hypersensitivity reactions may occur after administration of TUDORZA. If either of these occurs, treatment with TUDORZA should be stopped and other treatments considered.

Please see additional Important Safety Information throughout, and [click here](#) to see the full Prescribing Information.

# MPR PRESCRIBING ALERT

✓ In a 24-week placebo-controlled study (ATTAIN) TUDORZA provided statistically significant improvements in morning trough (predose) lung function at 12 weeks and 24 weeks<sup>2,4</sup>

## ATTAIN—CHANGES IN LUNG FUNCTION

**Morning trough (predose) FEV<sub>1</sub>, change from baseline vs placebo at 12 and 24 weeks<sup>2,4</sup>**

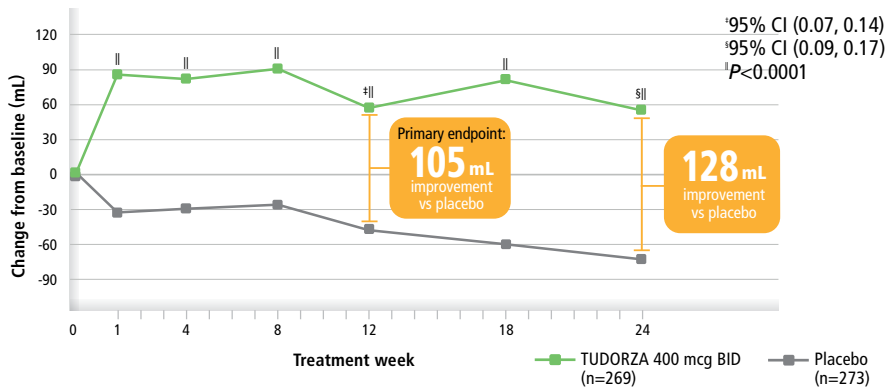

**Study design:** A randomized, double-blind, 24-week study in patients with moderate to severe COPD (N=542) that assessed the long-term bronchodilator efficacy and safety of inhaled TUDORZA. Mean patient age was 62.5 years; 68.5% male, 95.4% Caucasian. Rescue medication, corticosteroids, methylxanthines (theophylline), and oxygen therapy were allowed as concomitant treatments. Major relevant medication classes not allowed included long-acting beta agonists, short-acting muscarinic antagonists, long-acting muscarinic antagonists, and long-acting beta agonist/inhaled corticosteroid combinations.<sup>1,2,4</sup>

The primary endpoint was the change from baseline in morning trough (predose) FEV<sub>1</sub> at 12 weeks. Morning trough (predose) FEV<sub>1</sub> was defined as FEV<sub>1</sub> measured 12 hours after the previous evening dose of TUDORZA.<sup>1,2,4</sup>

Mean baseline values for morning trough (predose) FEV<sub>1</sub> were 1.51 L for the TUDORZA study group and 1.50 L for the placebo study group. Mean percentage of bronchodilator reversibility was 11.3% (146 mL) for the TUDORZA study group and 12.3% (143 mL) for the placebo study group.<sup>1,2</sup>

COPD = chronic obstructive pulmonary disease; FEV<sub>1</sub> = forced expiratory volume in 1 second.

✓ In a separate 12-week placebo-controlled study (ACCORD COPD II) TUDORZA provided statistically significant improvements in morning trough (predose) lung function at 12 weeks<sup>2</sup>

## ACCORD COPD II—CHANGES IN LUNG FUNCTION

**Morning trough (predose) FEV<sub>1</sub>, change from baseline vs placebo at 12 weeks<sup>2</sup>**

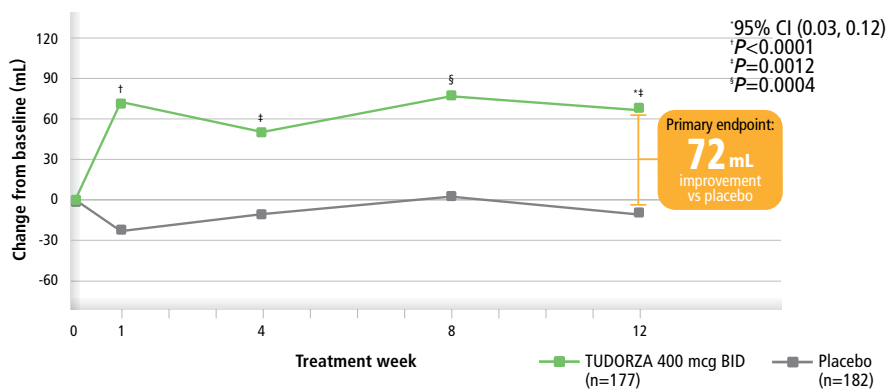

**Study design:** A randomized, double-blind, 12-week study in patients with moderate to severe COPD (N=359) that assessed the bronchodilator efficacy and safety of inhaled TUDORZA. Mean patient age was 62.5 years; 52.6% male, 91.4% Caucasian. Rescue medication, corticosteroids, methylxanthines (theophylline), and oxygen therapy were allowed as concomitant treatments. Major relevant medication classes not allowed included long-acting beta agonists, short-acting muscarinic antagonists, long-acting muscarinic antagonists, and long-acting beta agonist/inhaled corticosteroid combinations.<sup>1,2</sup>

The primary endpoint was the change from baseline in morning trough (predose) FEV<sub>1</sub> at 12 weeks. Morning trough (predose) FEV<sub>1</sub> was defined as FEV<sub>1</sub> measured 12 hours after the previous evening dose of TUDORZA.<sup>1,2</sup>

Mean baseline values for morning trough (predose) FEV<sub>1</sub> were 1.25 L for the TUDORZA study group and 1.46 L for the placebo study group. Mean percentage of bronchodilator reversibility was 17.0% (190 mL) for the TUDORZA study group and 15.7% (190 mL) for the placebo study group.<sup>1,2</sup>

COPD = chronic obstructive pulmonary disease; FEV<sub>1</sub> = forced expiratory volume in 1 second.

### Important Safety Information (*continued*)

- TUDORZA should be used with caution in patients with narrow-angle glaucoma or urinary retention. Instruct patients to consult a physician immediately should any signs or symptoms of narrow-angle glaucoma or prostatic hyperplasia or bladder-neck obstruction develop.
- Patients with a history of hypersensitivity reactions to atropine should be closely monitored for similar hypersensitivity reactions to TUDORZA. Use with caution in patients with severe hypersensitivity to milk proteins.
- The most common adverse reactions ( $\geq 3\%$  incidence and greater than placebo) were headache (6.6% vs 5.0%), nasopharyngitis (5.5% vs 3.9%), and cough (3.0% vs 2.2%), for TUDORZA vs placebo, respectively.

Please see additional Important Safety Information throughout, and [click here](#) to see the full Prescribing Information.

# MPR PRESCRIBING ALERT



In a subset of patients in a 12-week placebo-controlled study (ACCORD COPD I) TUDORZA demonstrated improvements in FEV<sub>1</sub> for 12 hours after the first dose that were consistent over 12 weeks<sup>1,2</sup>

- Results of 2 additional placebo-controlled studies were similar<sup>1</sup>
- These results were also consistent through 24 weeks<sup>1</sup>

## MEAN SERIAL SPIROMETRY FEV<sub>1</sub> OVER 12 HOURS ON THE FIRST DAY OF TREATMENT AND AT 12 WEEKS<sup>1,2</sup>

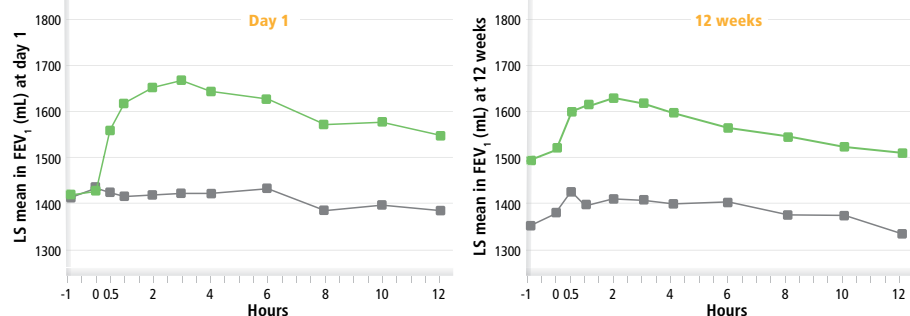

**Study design:** A randomized, double-blind, 12-week study in patients with moderate to severe COPD (N=375) that assessed the bronchodilator efficacy and safety of inhaled TUDORZA. Mean patient age was 65 years; 52.1% male, 94.7% Caucasian. Rescue medication, corticosteroids, methylxanthines (theophylline), and oxygen therapy were allowed as concomitant treatments. Major relevant medication classes not allowed included long-acting beta agonists, short-acting muscarinic antagonists, long-acting muscarinic antagonists, and long-acting beta agonist/inhaled corticosteroid combinations.<sup>1,3</sup>

The primary endpoint was the change from baseline in morning trough (predose) FEV<sub>1</sub> at 12 weeks. See page 1 for the results of this study.<sup>1,2</sup> Mean FEV<sub>1</sub> was measured using serial spirometry, an assessment of lung function recorded at prespecified time points throughout the day. A subset population was used to assess 12-hour spirometry in approximately 40% of all study patients (n=146).<sup>2</sup>

Charts represent spirometry values at each time point and not change from baseline

TUDORZA 400 mcg BID (n=73) Placebo (n=73)

COPD = chronic obstructive pulmonary disease; FEV<sub>1</sub> = forced expiratory volume in 1 second.

- Peak lung function in all 3 placebo-controlled studies: Mean peak improvements in FEV<sub>1</sub> relative to baseline observed after the first dose on day 1 were similar at 12 weeks<sup>1</sup>



In 2 of 3 placebo-controlled studies (ACCORD COPD I and ATTAIN) TUDORZA reduced the frequency of use of daily rescue medication<sup>1</sup>

- In a third study (ACCORD COPD II) TUDORZA did not demonstrate an effect vs placebo on rescue medication use<sup>2</sup>

## PUFFS OF RESCUE ALBUTEROL PER DAY VS PLACEBO<sup>2</sup>

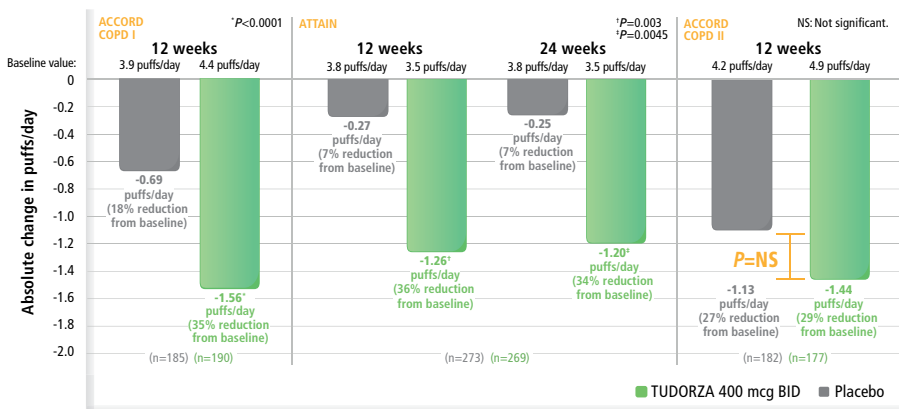

**Study design for ACCORD COPD I:** A randomized, double-blind, 12-week study in patients with moderate to severe COPD (N=375) that assessed the bronchodilator efficacy and safety of inhaled TUDORZA. Mean patient age was 65 years; 52.1% male, 94.7% Caucasian. Mean baseline values for morning trough (predose) FEV<sub>1</sub> were 1.33 L for the TUDORZA study group and 1.38 L for the placebo study group. Mean percentage of bronchodilator reversibility was 15.5% (186 mL) for the TUDORZA study group and 17.1% (190 mL) for the placebo study group.<sup>1,3</sup>

**Study design for ATTAIN:** A randomized, double-blind, 24-week study in patients with moderate to severe COPD (N=542) that assessed the long-term bronchodilator efficacy and safety of inhaled TUDORZA. Mean patient age was 62.5 years; 68.5% male, 95.4% Caucasian. Mean baseline values for morning trough (predose) FEV<sub>1</sub> were 1.51 L for the TUDORZA study group and 1.50 L for the placebo study group. Mean percentage of bronchodilator reversibility was 11.3% (146 mL) for the TUDORZA study group and 12.3% (143 mL) for the placebo study group.<sup>1,2,4</sup>

**Study design for ACCORD COPD II:** A randomized, double-blind, 12-week study in patients with moderate to severe COPD (N=359) that assessed the bronchodilator efficacy and safety of inhaled TUDORZA. Mean patient age was 62.5 years; 52.6% male, 91.4% Caucasian. Mean baseline values for morning trough (predose) FEV<sub>1</sub> were 1.25 L for the TUDORZA study group and 1.46 L for the placebo study group. Mean percentage of bronchodilator reversibility was 17.0% (190 mL) for the TUDORZA study group and 15.7% (190 mL) for the placebo study group.<sup>1,2</sup>

COPD = chronic obstructive pulmonary disease; FEV<sub>1</sub> = forced expiratory volume in 1 second.

The primary endpoint for all 3 studies was the change from baseline in morning trough (predose) FEV<sub>1</sub> at 12 weeks. Change from baseline in rescue medication use was an additional endpoint.<sup>1-4</sup> In all 3 studies, rescue medication, corticosteroids, methylxanthines (theophylline), and oxygen therapy were allowed as concomitant treatments. Major relevant medication classes not allowed included long-acting beta agonists, short-acting muscarinic antagonists, long-acting muscarinic antagonists, and long-acting beta agonist/inhaled corticosteroid combinations.<sup>1-4</sup>

## Important Safety Information

- TUDORZA PRESSAIR is not indicated for the initial treatment of acute episodes of bronchospasm (ie, rescue therapy).
- Inhaled medicines, including TUDORZA, may cause paradoxical bronchospasm. In addition, immediate hypersensitivity reactions may occur after administration of TUDORZA. If either of these occurs, treatment with TUDORZA should be stopped and other treatments considered.

Please see additional Important Safety Information throughout, and [click here](#) to see the full Prescribing Information.

# MPR PRESCRIBING ALERT

✓ **No overall differences in efficacy or safety were observed between older ( $\geq 70$  years) and younger ( $< 70$  years) adult patients in 3 placebo-controlled studies<sup>1</sup>**

- Analysis reflects exposure of 636 patients to TUDORZA 400 mcg twice daily for up to 24 weeks in 3 placebo-controlled studies; 167 were  $\geq 70$  years of age, and 469 were  $< 70$  years of age<sup>1</sup>
- Other reported clinical experience has not identified differences in responses between older and younger patients<sup>1</sup>
- Greater sensitivity of some older individuals cannot be ruled out<sup>1</sup>
- The safety and effectiveness of TUDORZA PRESSAIR in pediatric patients have not been established. COPD does not normally occur in children<sup>1</sup>

✓ **TUDORZA is administered using the preloaded, multiple-dose, dry powder PRESSAIR® inhaler<sup>1</sup>**

- **Preloaded** with 60 doses for 1 month of treatment<sup>1</sup>
- **Colored control window** provides confirmation of successful inhalation<sup>1</sup>
  - Turns from red to green when the dose is ready, and from green to red when the patient has inhaled the full dose of medication correctly
- A “**click**” sounds during inhalation when the patient is using the inhaler correctly<sup>1</sup>
  - Patients should keep breathing in after the “click” to be sure they get the full dose
- **Dose indicator** shows patients approximately how many doses remain in the inhaler<sup>1</sup>
  - Number of doses counts down in intervals of 10 (60, 50, 40, 30, 20, 10, 0) with use
- Patients should discard the PRESSAIR inhaler and start a new one when<sup>1</sup>
  - The marking “0” with a red background shows in the middle of the dose indicator, *or*
  - The device locks out, *or*
  - 45 days have passed since they took the inhaler out of the sealed pouch, whichever comes first
- If the inhaler appears damaged or the cap is lost, the inhaler should be replaced<sup>1</sup>
- **For a complete description of how to use the TUDORZA PRESSAIR inhaler, see the step-by-step Instructions for Use within the full Prescribing Information**

## SIDE EFFECTS OCCURRING IN THE TUDORZA GROUP AT A FREQUENCY OF $\geq 1\%$ AND EXCEEDING PLACEBO\*<sup>1</sup>

Side Effects	TUDORZA (N=636) n (%)	Placebo (N=640) n (%)
Headache	42 (6.6)	32 (5.0)
Nasopharyngitis	35 (5.5)	25 (3.9)
Cough	19 (3.0)	14 (2.2)
Diarrhea	17 (2.7)	9 (1.4)
Sinusitis	11 (1.7)	5 (0.8)
Rhinitis	10 (1.6)	8 (1.2)
Toothache	7 (1.1)	5 (0.8)
Fall	7 (1.1)	3 (0.5)
Vomiting	7 (1.1)	3 (0.5)

\*Pooled safety analysis from one 6-month and two 3-month placebo-controlled studies.

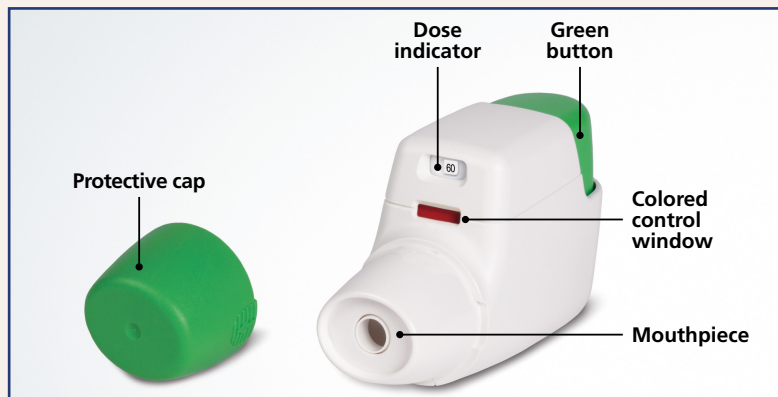

## Important Safety Information (*continued*)

- TUDORZA should be used with caution in patients with narrow-angle glaucoma or urinary retention. Instruct patients to consult a physician immediately should any signs or symptoms of narrow-angle glaucoma or prostatic hyperplasia or bladder-neck obstruction develop.
- Patients with a history of hypersensitivity reactions to atropine should be closely monitored for similar hypersensitivity reactions to TUDORZA. Use with caution in patients with severe hypersensitivity to milk proteins.
- The most common adverse reactions ( $\geq 3\%$  incidence and greater than placebo) were headache (6.6% vs 5.0%), nasopharyngitis (5.5% vs 3.9%), and cough (3.0% vs 2.2%), for TUDORZA vs placebo, respectively.

Please see additional Important Safety Information throughout, and [click here](#) to see the full [Prescribing Information](#).

## REFERENCES

1. TUDORZA PRESSAIR (aclidinium bromide inhalation powder) Prescribing Information. Forest Pharmaceuticals, Inc. St. Louis, MO.
2. Data on file. Forest Laboratories, Inc.
3. Kerwin EM, D'Urzo AD, Gelb AF, et al, on behalf of the ACCORD I study investigators. Efficacy and safety of a 12-week treatment with twice-daily aclidinium bromide in COPD patients (ACCORD COPD I). *COPD*. 2012;9:90-101.
4. Jones PW, Singh D, Bateman ED, et al. Efficacy and safety of twice-daily aclidinium bromide in COPD patients: the ATTAIN study. *Eur Respir J*. 2012;40(4):830-836.

## HIGHLIGHTS OF PRESCRIBING INFORMATION

These highlights do not include all the information needed to use TUDORZA PRESSAIR safely and effectively. See full prescribing information for TUDORZA PRESSAIR.

**TUDORZA™ PRESSAIR™ (aclidinium bromide inhalation powder)**

### FOR ORAL INHALATION ONLY

**Initial U.S. Approval: 2012**

#### -----INDICATIONS AND USAGE-----

TUDORZA PRESSAIR is an anticholinergic indicated for the long-term maintenance treatment of bronchospasm associated with chronic obstructive pulmonary disease (COPD), including chronic bronchitis and emphysema. (1)

#### -----DOSAGE AND ADMINISTRATION-----

For oral inhalation only

- One inhalation of TUDORZA PRESSAIR 400 mcg twice daily. (2)

#### -----DOSAGE FORMS AND STRENGTHS-----

- Inhalation powder; The multi-dose device is a dry powder inhaler metering 400 mcg of aclidinium bromide per actuation. (3)

#### -----CONTRAINDICATIONS-----

None.

#### -----WARNINGS AND PRECAUTIONS-----

- Not for acute use: Not for use as a rescue medication. (5.1)

- Paradoxical bronchospasm: Discontinue TUDORZA PRESSAIR and consider other treatments if paradoxical bronchospasm occurs. (5.2)
- Worsening of narrow-angle glaucoma may occur. Use with caution in patients with narrow-angle glaucoma and instruct patients to consult a physician immediately if this occurs. (5.3)
- Worsening of urinary retention may occur. Use with caution in patients with prostatic hyperplasia or bladder-neck obstruction and instruct patients to consult a physician immediately if this occurs. (5.4)
- Immediate hypersensitivity reactions: Use with caution in patients with severe hypersensitivity to milk proteins. (5.5)

#### -----ADVERSE REACTIONS-----

Most common adverse reactions ( $\geq 3\%$  incidence and greater than placebo) are headache, nasopharyngitis and cough. (6.1)

**To report SUSPECTED ADVERSE REACTIONS, Contact Forest Laboratories, Inc. at 1-800-678-1605 or FDA at 1-800-FDA-1088 or [www.fda.gov/medwatch](http://www.fda.gov/medwatch).**

#### -----DRUG INTERACTIONS-----

Anticholinergics: May interact additively with concomitantly used anticholinergic medications. Avoid administrations of TUDORZA PRESSAIR with other anticholinergic-containing drugs. (7.2)

**See 17 for PATIENT COUNSELING INFORMATION AND FDA-approved patient labeling**

**REVISED: 07/2012**

**FULL PRESCRIBING INFORMATION: CONTENTS\***

- 1. INDICATIONS AND USAGE**
- 2. DOSAGE AND ADMINISTRATION**
- 3. DOSAGE FORMS AND STRENGTHS**
- 4. CONTRAINDICATIONS**
- 5. WARNINGS AND PRECAUTIONS**
  - 5.1 Not for Acute Use
  - 5.2 Paradoxical Bronchospasm
  - 5.3 Worsening of Narrow-Angle Glaucoma
  - 5.4 Worsening of Urinary Retention
  - 5.5 Immediate Hypersensitivity Reactions
- 6. ADVERSE REACTIONS**
  - 6.1 Clinical Trials Experience
- 7. DRUG INTERACTIONS**
  - 7.1 Sympathomimetics, Methylxanthines, Steroids
  - 7.2 Anticholinergics
- 8. USE IN SPECIFIC POPULATIONS**
  - 8.1 Pregnancy
  - 8.2 Labor and Delivery
  - 8.3 Nursing Mothers
  - 8.4 Pediatric Use
  - 8.5 Geriatric Use
  - 8.6 Renal Impairment
  - 8.7 Hepatic Impairment
- 10. OVERDOSAGE**
  - 10.1 Human Experience
- 11. DESCRIPTION**
- 12. CLINICAL PHARMACOLOGY**
  - 12.1 Mechanism of Action
  - 12.2 Pharmacodynamics
  - 12.3 Pharmacokinetics
- 13. NONCLINICAL TOXICOLOGY**
  - 13.1 Carcinogenesis, Mutagenesis, Impairment of Fertility
- 14. CLINICAL STUDIES**
  - 14.1 Chronic Obstructive Pulmonary Disease (COPD)
- 16. HOW SUPPLIED/STORAGE AND HANDLING**
  - 16.1 How Supplied
  - 16.2 Storage and Handling
- 17. PATIENT COUNSELING INFORMATION**
  - 17.1 Instructions for Administering TUDORZA PRESSAIR
  - 17.2 Acute Bronchospasm
  - 17.3 Paradoxical Bronchospasm
  - 17.4 Visual Effects
  - 17.5 Urinary Retention

\*Sections or subsections omitted from the full prescribing information are not listed

---

## FULL PRESCRIBING INFORMATION

### 1 INDICATIONS AND USAGE

TUDORZA™ PRESSAIR™ (aclidinium bromide inhalation powder) is indicated for the long-term, maintenance treatment of bronchospasm associated with chronic obstructive pulmonary disease (COPD), including chronic bronchitis and emphysema.

### 2 DOSAGE AND ADMINISTRATION

The recommended dose of TUDORZA PRESSAIR is one oral inhalation of 400 mcg, twice daily.

### 3 DOSAGE FORMS AND STRENGTHS

Inhalation Powder. TUDORZA PRESSAIR is a breath-actuated multi-dose dry powder inhaler metering 400 mcg of aclidinium bromide per actuation. Each actuation delivers 375 mcg of aclidinium bromide from the mouthpiece.

### 4 CONTRAINDICATIONS

None.

### 5 WARNINGS AND PRECAUTIONS

#### 5.1 Not for Acute Use

TUDORZA PRESSAIR is intended as a twice-daily maintenance treatment for COPD and is not indicated for the initial treatment of acute episodes of bronchospasm (i.e., rescue therapy).

#### 5.2 Paradoxical Bronchospasm

Inhaled medicines, including TUDORZA PRESSAIR, may cause paradoxical bronchospasm. If this occurs, treatment with TUDORZA PRESSAIR should be stopped and other treatments considered.

#### 5.3 Worsening of Narrow-Angle Glaucoma

TUDORZA PRESSAIR should be used with caution in patients with narrow-angle glaucoma. Prescribers and patients should be alert for signs and symptoms of acute narrow-angle glaucoma (e.g., eye pain or discomfort, blurred vision, visual halos or colored images in association with red eyes from conjunctival congestion and corneal edema). Instruct patients to consult a physician immediately should any of these signs or symptoms develop.

#### 5.4 Worsening of Urinary Retention

TUDORZA PRESSAIR should be used with caution in patients with urinary retention. Prescribers and patients should be alert for signs and symptoms of prostatic hyperplasia or bladder-neck obstruction (e.g., difficulty passing urine, painful urination). Instruct patients to consult a physician immediately should any of these signs or symptoms develop.

#### 5.5 Immediate Hypersensitivity Reactions

Immediate hypersensitivity reactions may occur after administration of TUDORZA PRESSAIR. If such a reaction occurs, therapy with TUDORZA PRESSAIR should be stopped at once and alternative treatments should be considered. Given the similar structural formula of atropine to aclidinium, patients with a history of hypersensitivity reactions to atropine should be closely monitored for similar hypersensitivity reactions to TUDORZA PRESSAIR. In addition, TUDORZA PRESSAIR should be used with caution in patients with severe hypersensitivity to milk proteins.

### 6 ADVERSE REACTIONS

The following adverse reactions are described in greater detail in other sections:

- Paradoxical bronchospasm [see *Warnings and Precautions (5.2)*]
- Worsening of narrow-angle glaucoma [see *Warnings and Precautions (5.3)*]
- Worsening of urinary retention [see *Warnings and Precautions (5.4)*]

#### 6.1 Clinical Trials Experience

Because clinical trials are conducted under widely varying conditions, adverse reaction rates observed in the clinical trials of a drug cannot be directly compared to rates in the clinical trials of another drug and may not reflect the rates observed in practice.

##### *3-Month and 6-Month Trials*

TUDORZA PRESSAIR was studied in two 3-month (Trials B and C) and one 6-month (Trial D) placebo-controlled trials in patients with COPD. In these trials, 636 patients were treated with TUDORZA PRESSAIR at the recommended dose of 400 mcg twice daily.

The population had a mean age of 64 years (ranging from 40 to 89 years), with 58% males, 94% Caucasian, and had COPD with a mean pre-bronchodilator forced expiratory volume in one second (FEV<sub>1</sub>) percent predicted of



48%. Patients with unstable cardiac disease, narrow-angle glaucoma, or symptomatic prostatic hypertrophy or bladder outlet obstruction were excluded from these trials.

Table 1 shows all adverse reactions that occurred with a frequency of greater than or equal to 1% in the TUDORZA PRESSAIR group in the two 3-month and one 6-month placebo-controlled trials where the rates in the TUDORZA PRESSAIR group exceeded placebo.

**Table 1: Adverse Reactions (% Patients) in Placebo-Controlled Clinical Trials**

Adverse Reactions Preferred Term	Treatment	
	TUDORZA PRESSAIR	Placebo
	(N=636) n (%)	(N=640) n (%)
Headache	42 (6.6)	32 (5.0)
Nasopharyngitis	35 (5.5)	25 (3.9)
Cough	19 (3.0)	14 (2.2)
Diarrhea	17 (2.7)	9 (1.4)
Sinusitis	11 (1.7)	5 (0.8)
Rhinitis	10 (1.6)	8 (1.2)
Toothache	7 (1.1)	5 (0.8)
Fall	7 (1.1)	3 (0.5)
Vomiting	7 (1.1)	3 (0.5)

In addition, among the adverse reactions observed in the clinical trials with an incidence of less than 1% were diabetes mellitus, dry mouth, 1st degree AV block, osteoarthritis, cardiac failure, and cardio-respiratory arrest.

#### Long-term Safety Trials

TUDORZA PRESSAIR was studied in three long term safety trials, two double blind and one open label, ranging from 40 to 52 weeks in patients with moderate to severe COPD. Two of these trials were extensions of the 3-month trials, and one was a dedicated long term safety trial. In these trials, 891 patients were treated with TUDORZA PRESSAIR at the recommended dose of 400 mcg twice daily. The demographic and baseline characteristics of the long term safety trials were similar to those of the placebo-controlled trials. The adverse events reported in the long term safety trials were similar to those occurring in the placebo-controlled trials of 3 to 6 months. No new safety findings were reported compared to the placebo controlled trials.

## **7 DRUG INTERACTIONS**

*In vitro* studies suggest limited potential for CYP450-related metabolic drug interactions, thus no formal drug interaction studies have been performed with TUDORZA PRESSAIR [see *Clinical Pharmacology (12.3)*].

### **7.1 Sympathomimetics, Methylxanthines, Steroids**

In clinical studies, concurrent administration of acclidinium bromide and other drugs commonly used in the treatment of COPD including sympathomimetics (short-acting beta<sub>2</sub> agonists), methylxanthines, and oral and inhaled steroids showed no increases in adverse drug reactions.

### **7.2 Anticholinergics**

There is a potential for an additive interaction with concomitantly used anticholinergic medications. Therefore, avoid coadministration of TUDORZA PRESSAIR with other anticholinergic-containing drugs as this may lead to an increase in anticholinergic effects.

## **8 USE IN SPECIFIC POPULATIONS**

### **8.1 Pregnancy**

Teratogenic effects: Pregnancy Category C: There are no adequate and well controlled studies in pregnant women. Adverse development effects were observed in rats and rabbits exposed to acclidinium bromide. TUDORZA PRESSAIR should be used during pregnancy only if the potential benefit justifies the potential risk to the fetus.

Effects of acclidinium bromide on embryo-fetal development were examined in rats and rabbits. No evidence of structural alterations was observed in rats exposed during the period of organogenesis at approximately 15 times the recommended human daily dose (RHDD) [based on summed AUCs of acclidinium bromide and its metabolites at inhaled doses less than or equal to 5.0 mg/kg/day]. However, decreased pup weights were observed from dams exposed during the lactation period at approximately 5 times the RHDD [based on summed AUCs of acclidinium

bromide and its metabolites at inhaled doses greater than or equal to 0.2 mg/kg/day]. Maternal toxicity was also observed at inhaled doses greater than or equal to 0.2 mg/kg/day.

No evidence of structural alterations was observed in Himalayan rabbits exposed during the period of organogenesis at approximately 20 times the RHDD [based on summed AUCs of acclidinium bromide and its metabolites at inhaled doses less than or equal to 3.6 mg/kg/day]. However, increased incidences of additional liver lobes (3-5%), as compared to 0% in the control group, were observed at approximately 1,400 times the RHDD [based on summed AUCs of acclidinium bromide and its metabolites at oral doses greater than or equal to 150 mg/kg/day], and decreased fetal body weights were observed at approximately 2,300 times the RHDD [based on summed AUCs of acclidinium bromide and its metabolites at oral doses greater than or equal to 300 mg/kg/day]. These fetal findings were observed in the presence of maternal toxicity.

## **8.2 Labor and Delivery**

The effect of TUDORZA PRESSAIR on labor and delivery is unknown. TUDORZA PRESSAIR should be used during labor and delivery only if the potential benefit to the patient justifies the potential risk to the fetus.

## **8.3 Nursing Mothers**

Acclidinium bromide is excreted into the milk of lactating female rats, and decreased pup weights were observed. Excretion of acclidinium into human milk is probable. There are no human studies that have investigated the effects of TUDORZA PRESSAIR on breast-fed infants. Caution should be exercised when TUDORZA PRESSAIR is administered to nursing women.

## **8.4 Pediatric Use**

TUDORZA PRESSAIR is approved for use in the maintenance treatment of bronchospasm associated with COPD. COPD does not normally occur in children. The safety and effectiveness of TUDORZA PRESSAIR in pediatric patients have not been established.

## **8.5 Geriatric Use**

Of the 636 COPD patients exposed to TUDORZA PRESSAIR 400 mcg twice daily for up to 24 weeks in three placebo-controlled clinical trials, 197 were less than 60 years, 272 were greater than or equal to 60 to less than 70 years, and 167 were greater than or equal to 70 years of age. No overall differences in safety or effectiveness were observed between these subjects and younger subjects. Other reported clinical experience has not identified differences in responses between the elderly and younger patients, but greater sensitivity of some older individuals cannot be ruled out. Based on available data for TUDORZA PRESSAIR, no adjustment of dosage in geriatric patients is warranted [see *Clinical Pharmacology* (12.3)].

## **8.6 Renal Impairment**

The pharmacokinetics of TUDORZA PRESSAIR were investigated in subjects with normal renal function and in subjects with mild, moderate and severe renal impairment [see *Clinical Pharmacology* (12.3)]. No clinically significant differences in acclidinium pharmacokinetics were noted between these populations. Based on available data for TUDORZA PRESSAIR, no adjustment of dosage in renally impaired subjects is warranted.

## **8.7 Hepatic Impairment**

The effects of hepatic impairment on the pharmacokinetics of TUDORZA PRESSAIR were not studied [see *Clinical Pharmacology* (12.3)].

# **10 OVERDOSAGE**

## **10.1 Human Experience**

No case of overdose has been reported in clinical studies with TUDORZA PRESSAIR. There were no systemic anticholinergic or other adverse effects following a single inhaled dose of up to 6,000 mcg acclidinium bromide (7.5 times the RHDD) in 16 healthy volunteers.

# **11 DESCRIPTION**

TUDORZA PRESSAIR consists of a dry powder formulation of acclidinium bromide for oral inhalation only.

Acclidinium bromide, the active component of TUDORZA PRESSAIR is an anticholinergic with specificity for muscarinic receptors. Acclidinium bromide is a synthetic, quaternary ammonium compound, chemically described as 1-Azoniabicyclo[2.2.2]octane, 3-[(hydroxydi-2-thienylacetyl)oxy]-1-(3-phenoxypropyl)-, bromide, (3R)-. The structural formula is:

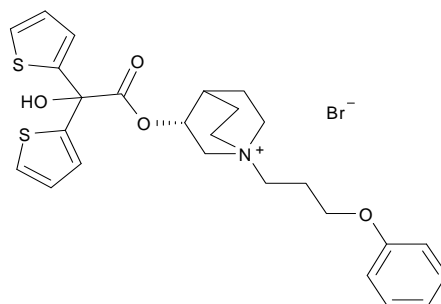

Acclidinium bromide is a white powder with a molecular formula of  $C_{26}H_{30}NO_4S_2Br$  and a molecular mass of 564.56. It is very slightly soluble in water and ethanol and sparingly soluble in methanol.

TUDORZA PRESSAIR is a breath-actuated multi-dose dry powder inhaler. Each actuation of TUDORZA PRESSAIR provides a metered dose of 13 mg of the formulation which contains lactose monohydrate (which may contain milk proteins) as the carrier and 400 mcg of acclidinium bromide. This results in delivery of 375 mcg acclidinium bromide from the mouthpiece, based on *in vitro* testing at an average flow rate of 63 L/min with constant volume of 2 L. The amount of drug delivered to the lungs will vary depending on patient factors such as inspiratory flow rate and inspiratory time. The PRESSAIR inhaler delivers the target dose at flow rates as low as 35 L/min. Based on a study in adult patients with moderate (N=24) and severe (N=24) COPD the mean peak inspiratory flow (PIF) was 95.3 L/min (range: 54.6 to 129.4 L/min) and 88.7 L/min (range: 72.0 to 106.4 L/min) respectively.

## 12 CLINICAL PHARMACOLOGY

### 12.1 Mechanism of Action

Acclidinium bromide is a long-acting antimuscarinic agent, which is often referred to as an anticholinergic. It has similar affinity to the subtypes of muscarinic receptors  $M_1$  to  $M_5$ . In the airways, it exhibits pharmacological effects through inhibition of  $M_3$  receptor at the smooth muscle leading to bronchodilation. The competitive and reversible nature of antagonism was shown with human and animal origin receptors and isolated organ preparations. In preclinical *in vitro* as well as *in vivo* studies, prevention of acetylcholine-induced bronchoconstriction effects was dose-dependent and lasted longer than 24 hours. The clinical relevance of these findings is unknown. The bronchodilation following inhalation of acclidinium bromide is predominantly a site-specific effect.

### 12.2 Pharmacodynamics

#### *Cardiovascular Effects*

In a thorough QT Study, 200 mcg and 800 mcg TUDORZA PRESSAIR was administered to healthy volunteers once daily for 3 days; no effects on prolongation of QT interval were observed using QTcF heart-rate correction methods.

Additionally, the effect of TUDORZA PRESSAIR on cardiac rhythm was assessed in 336 COPD patients, 164 patients received acclidinium bromide 400 mcg twice daily and 172 patients received placebo, using 24-hr Holter monitoring. No clinically significant effects on cardiac rhythm were observed.

### 12.3 Pharmacokinetics

#### *Absorption*

The absolute bioavailability of acclidinium bromide is approximately 6% in healthy volunteers. Following twice-daily oral inhalation administration of 400 mcg acclidinium bromide in healthy subjects, peak steady state plasma levels were observed within 10 minutes after inhalation.

#### *Distribution*

Acclidinium bromide shows a volume of distribution of approximately 300 L following intravenous administration of 400 mcg in humans.

#### *Metabolism*

Clinical pharmacokinetics studies, including a mass balance study, indicate that the major route of metabolism of acclidinium bromide is hydrolysis, which occurs both chemically and enzymatically by esterases. Acclidinium bromide is rapidly and extensively hydrolyzed to its alcohol and dithienylglycolic acid derivatives, neither of which binds to muscarinic receptors and are devoid of pharmacologic activity.

Therefore, due to the low plasma levels achieved at the clinically relevant doses, acclidinium bromide and its metabolites are not expected to alter the disposition of drugs metabolized by the human CYP450 enzymes.

### *Elimination*

Total clearance was approximately 170 L/h after an intravenous dose of acclidinium bromide in young healthy volunteers with an inter-individual variability of 36%. Intravenously administered radiolabelled acclidinium bromide was administered to healthy volunteers and was extensively metabolized with 1% excreted as unchanged acclidinium. Approximately 54% to 65% of the radioactivity was excreted in urine and 20% to 33% of the dose was excreted in feces. The combined results indicated that almost the entire acclidinium bromide dose was eliminated by hydrolysis. After dry powder inhalation, urinary excretion of acclidinium is about 0.09% of the dose and the estimated effective half-life is 5 to 8 hours.

### *Drug Interactions*

Formal drug interaction studies were not performed. *In vitro* studies using human liver microsomes indicated that acclidinium bromide and its major metabolites do not inhibit CYP450, 1A2, 2A6, 2B6, 2C8, 2C9, 2C19, 2D6, 2E1, 3A4/5 or 4A9/11 at concentrations up to 1,000-fold higher than the maximum plasma concentration that would be expected to be achieved at the therapeutic dose. Therefore, it is unlikely that acclidinium bromide causes CYP450 related drug interactions [see *Drug Interactions (7)*].

### *Specific Populations*

#### Elderly Patients

The pharmacokinetic profile of acclidinium bromide and its main metabolites was assessed in 12 elderly COPD patients (aged 70 years or older) compared to a younger cohort of 12 COPD patients (40-59 years) that were administered 400 mcg acclidinium bromide once daily for 3 days via inhalation. No clinically significant differences in systemic exposure (AUC and  $C_{max}$ ) were observed when the two groups were compared. No dosage adjustment is necessary in elderly patients [Use in *Specific Populations (8.5)*].

#### Renal Impairment

The impact of renal disease upon the pharmacokinetics of acclidinium bromide was studied in 18 subjects with mild, moderate, or severe renal impairment. Systemic exposure (AUC and  $C_{max}$ ) to acclidinium bromide and its main metabolites following single doses of 400 mcg acclidinium bromide was similar in renally impaired patients compared with 6 matched healthy control subjects. No dose adjustment is necessary in renally impaired patients [see *Use in Specific Populations (8.6)*].

#### Hepatic Impairment

The effects of hepatic impairment on the pharmacokinetics of acclidinium bromide were not studied. However, hepatic insufficiency is not expected to have relevant influence on acclidinium bromide pharmacokinetics, since it is predominantly metabolized by chemical and enzymatic hydrolysis to products that do not bind to muscarinic receptors [see *Use in Specific Populations (8.7)*].

## **13 NONCLINICAL TOXICOLOGY**

### **13.1 Carcinogenesis, Mutagenesis, Impairment of Fertility**

Two-year inhalation studies were conducted in mice and rats to assess the carcinogenic potential of acclidinium bromide. No evidence of tumorigenicity was observed in rats and mice at acclidinium doses up to 0.20 and 2.4 mg/kg/day, respectively [approximately 10 and 80 times the Recommended Human Daily Dose (RHDD)], respectively, based on summed AUCs of acclidinium bromide and its metabolites].

Acclidinium bromide was positive in the *in vitro* bacterial gene mutation assay and the *in vitro* thymidine locus mouse lymphoma assay. However, acclidinium bromide was negative in the *in vivo* mouse micronucleus assay and the *in vivo/in vitro* unscheduled DNA synthesis assay with rat liver.

Acclidinium bromide impaired several fertility and reproductive performance indices (increased number of days to mate, decreased conception rate, decreased number of corpora lutea, increased pre-implantation loss with consequent decreased number of implantations and live embryos) in both male and female rats administered inhaled doses greater than or equal to 0.8 mg/kg/day [approximately 15 times the RHDD based on summed AUCs of acclidinium bromide and its metabolites]. These adverse fertility effects were observed in the presence of paternal toxicity as evidenced by mortality and decreased body weight gain. However, there were no effects on mating index and sperm number and morphology. In the separate fertility assessments (treated males mated with untreated females; treated females mated with untreated males), no effect was observed in male and female rats at inhaled dose of 1.9 and 0.8 mg/kg/day, respectively [approximately 30 and 15 times the RHDD, respectively, based on summed AUCs of acclidinium bromide and its metabolites].

## 14 CLINICAL STUDIES

### 14.1 Chronic Obstructive Pulmonary Disease (COPD)

The TUDORZA PRESSAIR clinical development program included a dose-ranging trial (Trial A) for nominal dose selection and three confirmatory trials (Trials B, C, and D).

#### *Dose-ranging trial*

Trial A was a randomized, double-blind, placebo-controlled, active-controlled, cross-over trial with 7-day treatment periods separated by 5-day washout periods. Trial A enrolled 79 patients who had a clinical diagnosis of COPD, were 40 years of age or older, had a history of smoking at least 10 pack-years, had a forced expiratory volume in one second (FEV<sub>1</sub>) of at least 30% and less than 80% of predicted normal value, and a ratio of FEV<sub>1</sub> over forced vital capacity (FEV<sub>1</sub>/FVC) of less than 0.7. Trial A included TUDORZA PRESSAIR doses of 400 mcg, 200 mcg and 100 mcg twice daily, formoterol active control, and placebo. Trial A demonstrated that the effect on trough FEV<sub>1</sub> and serial FEV<sub>1</sub> in patients treated with the TUDORZA PRESSAIR 100 mcg twice daily and 200 mcg twice daily doses was lower compared to patients treated with the TUDORZA PRESSAIR 400 mcg twice daily dose (Figure 1).

**Figure 1. Change from baseline in FEV<sub>1</sub> Over Time (prior to and after administration of study drug) at Week 1 in Trial A**

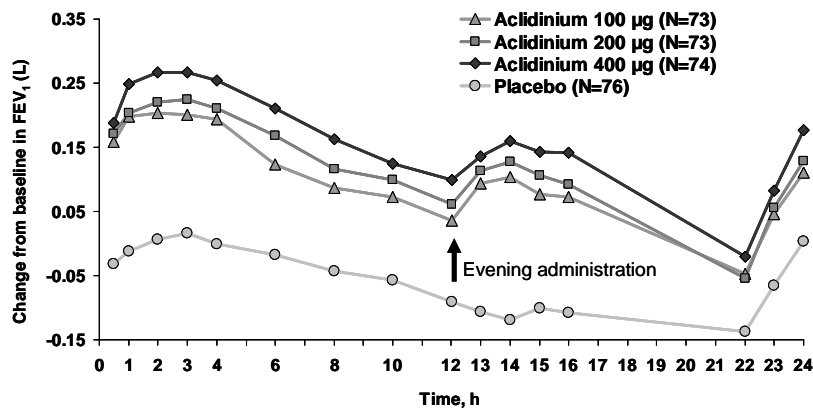

#### *Confirmatory trials*

Trials B, C, and D were three randomized, double-blind, placebo-controlled trials in patients with COPD. Trials B and C were 3 months in duration, and Trial D was 6 months in duration. These trials enrolled 1,276 patients who had a clinical diagnosis of COPD, were 40 years of age or older, had a history of smoking at least 10 pack-years, had an FEV<sub>1</sub> of at least 30% and less than 80% of predicted normal value, and a ratio of FEV<sub>1</sub>/FVC of less than 0.7; 59% were male, and 93% were Caucasian.

These clinical trials evaluated TUDORZA PRESSAIR 400 mcg twice daily (636 patients) and placebo (640 patients). TUDORZA PRESSAIR 400 mcg resulted in statistically significantly greater bronchodilation as measured by change from baseline in morning pre-dose FEV<sub>1</sub> at 12 weeks (the primary efficacy endpoint) compared to placebo in all three trials (Table 2).

**Table 2: Change from Baseline in Trough FEV<sub>1</sub> (L) at Week 12**

Treatment Arm	Baseline	Change from Baseline LS Mean (SE)	Treatment Difference LS Mean (95% CI)
<b>Trial B (N=375)</b>			
Acclidinium 400 mcg	1.33	0.10 (0.01)	0.12 (0.08, 0.16)
Placebo	1.38	-0.02 (0.02)	
<b>Trial C (N=359)</b>			
Acclidinium 400 mcg	1.25	0.06 (0.02)	0.07 (0.03, 0.12)
Placebo	1.46	-0.01 (0.02)	
<b>Trial D* (N=542)</b>			
Acclidinium 400 mcg	1.51	0.06 (0.02)	0.11 (0.07, 0.14)
Placebo	1.50	-0.05 (0.02)	

SE=standard error, and LS mean=least square mean. LS mean, and 95% confidence interval were obtained from an ANCOVA model with change from baseline in trough FEV<sub>1</sub> as response, with treatment group and sex as factors and baseline trough FEV<sub>1</sub> and age as covariates.

\*In the 6-month Trial D, placebo adjusted change from baseline in Trough FEV<sub>1</sub> at 24 weeks was 0.13 (0.09, 0.17).

Serial spirometric evaluations were performed throughout daytime hours in a subset of patients in the three trials. The serial FEV<sub>1</sub> values over 12 hours for one of the 3-month trials (Trial B) are displayed in Figure 2. Results for the other two placebo-controlled trials were similar to the results for Trial B. Improvement of lung function was maintained for 12 hours after a single dose and was consistent over the 3- or 6-month treatment period.

**Figure 2. Mean FEV<sub>1</sub> Over Time (prior to and after administration of study drug) on Day 1 and Week 12 in Subset of Patients Participating in the 12 hours Serial Spirometry Substudy for Trial B (a 3-month Placebo-Controlled Study)**

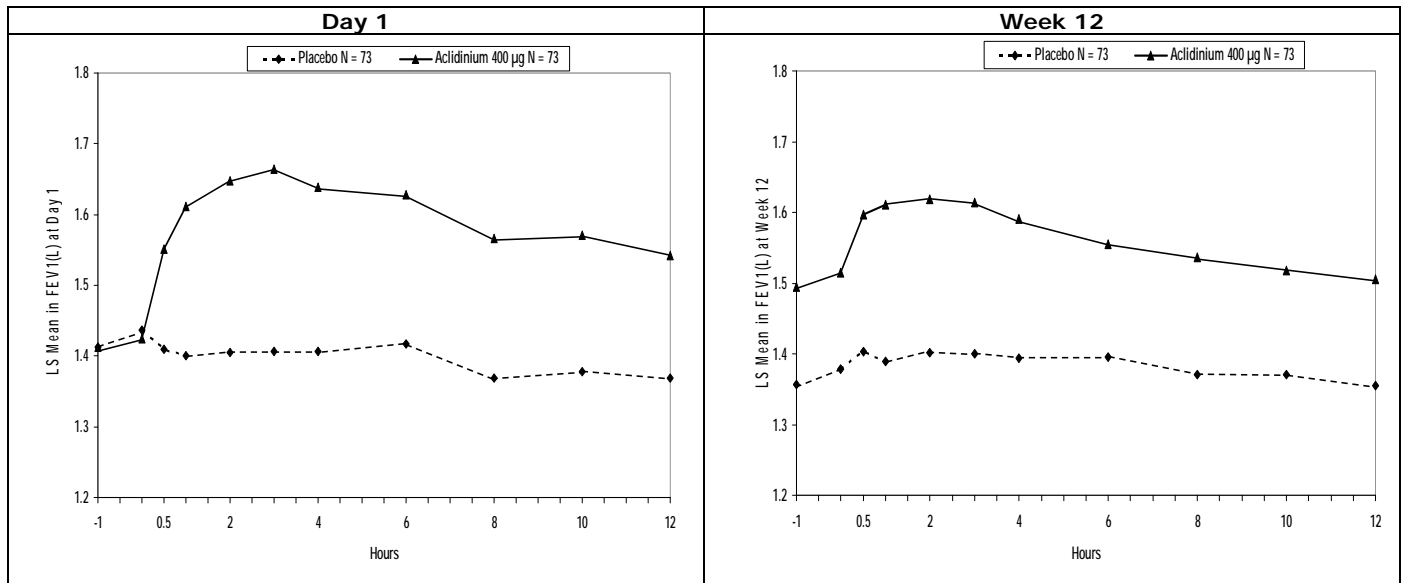

Mean peak improvements in FEV<sub>1</sub> for TUDORZA PRESSAIR relative to baseline were assessed in all patients in trials B, C and D after the first dose on day 1 and were similar at week 12. In Trials B and D but not in Trial C, patients treated with TUDORZA PRESSAIR used less daily rescue albuterol during the trial compared to patients treated with placebo.

## **16 HOW SUPPLIED/STORAGE AND HANDLING**

### **16.1 How Supplied**

TUDORZA™ PRESSAIR™ (aclidinium bromide inhalation powder) 400 mcg is supplied in a sealed labeled aluminum pouch and is available in 60 metered doses (NDC 0456-0800-60).

The active ingredient is administered using a multi-dose dry powder inhaler, PRESSAIR™, which delivers 60 doses of aclidinium bromide powder for oral inhalation. The PRESSAIR inhaler is a white and green colored device and is comprised of an assembled plastic dosing mechanism with a dose indicator, a drug-product storage unit containing the drug-product formulation, and a mouthpiece covered by a green protective cap. The inhaler should be discarded when the marking "0" with a red background shows in the middle of the dose indicator or when the device locks out, whichever comes first.

### **16.2 Storage and Handling**

Store TUDORZA PRESSAIR in a dry place at 25°C (77°F); excursions permitted to 15-30°C (59-86°F) [*see USP Controlled Room Temperature*].

The PRESSAIR inhaler should be stored inside the sealed pouch and only be opened immediately before use.

Discard the PRESSAIR inhaler 45 days after opening the pouch, after the marking "0" with a red background shows in the middle of the dose indicator, or when the device locks out, whichever comes first.

Keep out of reach of children.

## **17 PATIENT COUNSELING INFORMATION**

*See FDA-approved Patient Labeling (Patient Information and Instructions for Use)*

### **17.1 Instructions for Administering TUDORZA PRESSAIR**

It is important for patients to understand how to correctly use TUDORZA PRESSAIR.

**Inform patients that if they miss a dose, they should take their next dose at the usual time; they should not take 2 doses at one time.**

### **17.2 Acute Bronchospasm**

Instruct patients that TUDORZA PRESSAIR is a twice daily maintenance bronchodilator and should not be used for immediate relief of breathing problems (i.e., as a rescue medication) [*see Warnings and Precautions (5.1)*].

### **17.3 Paradoxical Bronchospasm**

Inform patients that TUDORZA PRESSAIR can cause paradoxical bronchospasm. Advise patients that if paradoxical bronchospasm occurs, patients should discontinue TUDORZA PRESSAIR [*see Warnings and Precautions (5.2)*].

### **17.4 Visual Effects**

Eye pain or discomfort, blurred vision, visual halos or colored images in association with red eyes from conjunctival congestion and corneal edema may be signs of acute narrow-angle glaucoma. Inform patients to consult a physician immediately should any of these signs and symptoms develop. Advise patients that miotic eye drops alone are not considered to be effective treatment [*see Warnings and Precautions (5.3)*].

Inform patients that care must be taken not to allow the powder to enter into the eyes as this may cause blurring of vision and pupil dilation.

### **17.5 Urinary Retention**

Difficulty passing urine and dysuria may be symptoms of new or worsening prostatic hyperplasia or bladder outlet obstruction. Patients should be instructed to consult a physician immediately should any of these signs or symptoms develop [*see Warnings and Precautions (5.4)*].

Distributed by:  
Forest Pharmaceuticals, Inc.  
Subsidiary of Forest Laboratories, Inc.  
St. Louis, MO 63045

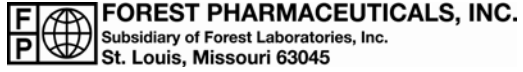

Under license of ALMIRALL



**TUDORZA** and **PRESSAIR** are trademarks of ALMIRALL.

© 2012 Forest Laboratories, Inc.

RMC XXXX



## Patient Information

### **TUDORZA™ PRESSAIR™ (TU-door-za PRESS-air)** (aclidinium bromide inhalation powder)

#### **FOR ORAL INHALATION ONLY**

Read the Patient Information that comes with TUDORZA PRESSAIR before you start using it and each time you get a refill. There may be new information. This Patient Information does not take the place of talking to your doctor about your medical condition or your treatment.

#### **What is TUDORZA PRESSAIR?**

**TUDORZA PRESSAIR is a prescription medicine used long term, 2 times each day to treat symptoms of chronic obstructive pulmonary disease (COPD), including chronic bronchitis and emphysema.** You may start to feel like it is easier to breathe on the first day, but it may take longer for you to feel the full effects of the medicine. TUDORZA PRESSAIR works best and may help make it easier to breathe when you use it every day.

TUDORZA PRESSAIR is **not** a rescue medicine and should not be used for treating sudden breathing problems. Your doctor may give you other medicine to use for sudden breathing problems.

**It is not known if TUDORZA PRESSAIR is safe and effective in children.**

#### **What should I tell my doctor before using TUDORZA PRESSAIR?**

**Before you use TUDORZA PRESSAIR, tell your doctor about all your medical conditions, including if you:**

- have eye problems, especially glaucoma. TUDORZA PRESSAIR may make your glaucoma worse.
- have prostate or bladder problems, or problems passing urine. TUDORZA PRESSAIR may make these problems worse.
- have a severe allergy to milk proteins. Ask your doctor if you are not sure.
- are pregnant or plan to become pregnant. It is not known if TUDORZA PRESSAIR can harm your unborn baby.
- are breastfeeding or plan to breastfeed. TUDORZA PRESSAIR may pass into your breast milk. You and your doctor should decide if you will take TUDORZA PRESSAIR.

**Tell your doctor about all the medicines you take**, including prescription and non-prescription medicines and eye drops, vitamins, and herbal supplements.

TUDORZA PRESSAIR and certain other medicines may interact with each other. This may cause serious side effects.

Especially tell your doctor if you take:

- anticholinergics (including Tiotropium, Ipratropium)
- atropine

Ask your doctor or pharmacist for a list of these medicines if you are not sure.

Know the medicines you take. Keep a list of them to show your doctor and pharmacist each time you get a new medicine.

### **How should I use TUDORZA PRESSAIR?**

**See the step-by-step instructions for using TUDORZA PRESSAIR at the end of this Patient Information.**

- Use TUDORZA PRESSAIR exactly as prescribed.
- The usual dose of TUDORZA PRESSAIR is one oral inhalation 2 times a day. Each dose should be about 12 hours apart.
- If you miss a dose, just skip the dose. Take your next dose at your usual time. Do not take 2 doses at one time.

**TUDORZA PRESSAIR does not relieve sudden symptoms of COPD.** Always have a rescue inhaler medicine with you to treat sudden symptoms. If you do not have a rescue inhaler medicine, call your doctor to have one prescribed for you.

**Do not use TUDORZA PRESSAIR more often than prescribed or take more medicine than prescribed for you.**

- **Call your doctor or get emergency medical care right away if:**
  - your breathing problems worsen with TUDORZA PRESSAIR
  - you need to use your rescue inhaler medicine more often than usual
  - your rescue inhaler medicine does not work as well for you at relieving symptoms

### **What are the possible side effects of TUDORZA PRESSAIR?**

**TUDORZA PRESSAIR can cause serious side effects including:**

- **sudden shortness of breath immediately after use of TUDORZA PRESSAIR.** If you have this symptom, stop taking TUDORZA PRESSAIR and call your doctor right away or go to the nearest hospital emergency room.

- **new or worsened increased pressure in your eyes (acute narrow-angle glaucoma).** Acute narrow-angle glaucoma can lead to permanent loss of vision if not treated. Symptoms of acute narrow-angle glaucoma may include:
  - eye pain or discomfort
  - nausea or vomiting
  - blurred vision
  - seeing halos or bright colors around lights
  - red eyes

Using only eye drops to treat these symptoms may not work. If you have these symptoms, stop taking TUDORZA PRESSAIR and call your doctor right away.

- **new or worsened urinary retention.** Urinary retention can be caused by blockage in your bladder or, if you are a male, a larger than normal prostate. Symptoms of urinary retention may include:
  - difficulty urinating
  - painful urination
  - urinating frequently
  - urination in a weak stream or drips

If you have these symptoms of urinary retention, stop taking TUDORZA PRESSAIR and call your doctor right away.

- **serious allergic reactions including rash, hives, swelling of the face, mouth, and tongue, and breathing problems.** Call your doctor or get emergency medical care if you get any symptoms of a serious allergic reaction.

The most common side effects of TUDORZA PRESSAIR include:

- headache
- common cold symptoms
- cough

**If your COPD symptoms worsen over time do not increase your dose of TUDORZA PRESSAIR, instead call your doctor.**

Tell your doctor if you get any side effect that bothers you or does not go away.

These are not all the possible side effects with TUDORZA PRESSAIR. Ask your doctor or pharmacist for more information.

**Call your doctor for medical advice about side effects. You may report side effects to FDA at 1-800-FDA-1088.**

#### **How should I store TUDORZA PRESSAIR?**

Store TUDORZA PRESSAIR at room temperature between 68°F to 77°F (20° to 25°C) in the protective pouch. **Do not open the sealed pouch until you are ready to use a dose of TUDORZA PRESSAIR. Once a sealed pouch is opened, start using**

**your TUDORZA PRESSAIR.** Discard the PRESSAIR inhaler 45 days after opening the pouch, after the marking "0" with a red background shows in the middle of the dose indicator, or when the device locks out, whichever comes first.

- Keep TUDORZA PRESSAIR in a dry place.
- Do not store the inhaler on a vibrating surface.

**Keep TUDORZA PRESSAIR and all medicines out of the reach of children.**

### **General information about the safe and effective use of TUDORZA PRESSAIR**

Medicines are sometimes prescribed for purposes other than those listed in Patient Information leaflets. Do not use TUDORZA PRESSAIR for a condition for which it was not prescribed. Do not give TUDORZA PRESSAIR to other people even if they have the same symptoms that you have. It may harm them.

This patient leaflet summarizes the most important information about TUDORZA PRESSAIR. If you would like more information, talk with your doctor. You can ask your pharmacist or doctor for information about TUDORZA PRESSAIR that is written for health professionals.

For more information, go to [www.tudorza.com](http://www.tudorza.com), or a call 1-800-678-1605.

### **What are the ingredients in TUDORZA PRESSAIR?**

Active ingredient: aclidinium bromide

Inactive ingredient: lactose monohydrate

## Instructions for Use

### TUDORZA™ PRESSAIR™ (TU-door-za PRESS-air) (aclidinium bromide inhalation powder)

#### FOR ORAL INHALATION ONLY

Read this Instructions for Use before you start using TUDORZA PRESSAIR and each time you get a refill. There may be new information. This information does not take the place of talking to your doctor about your medical condition or your treatment.

#### Your TUDORZA PRESSAIR INHALER:

When you are ready to use TUDORZA PRESSAIR for the first time, remove the TUDORZA PRESSAIR inhaler from the pouch. To remove the inhaler from the pouch, tear along the “notch.” The pouch may then be discarded.

Look at the parts of the inhaler so you become familiar with them. (See Figure A)

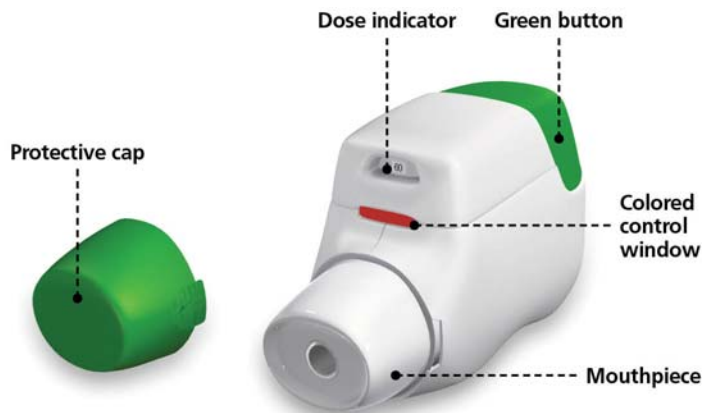
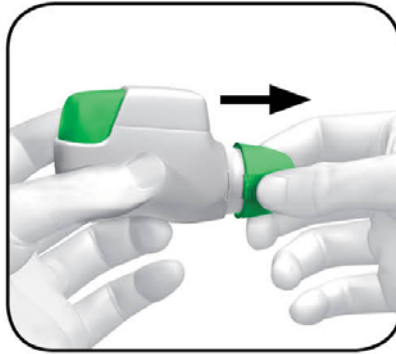

Figure A

Taking a dose from the TUDORZA PRESSAIR Inhaler requires you to press, release, and inhale. See the step-by-step instructions for using TUDORZA PRESSAIR below.

#### How to prepare and use your TUDORZA PRESSAIR Inhaler

**Step 1.** Remove the protective cap by **lightly squeezing the arrows** marked on each side of the cap and pulling outwards. (See Figure B)

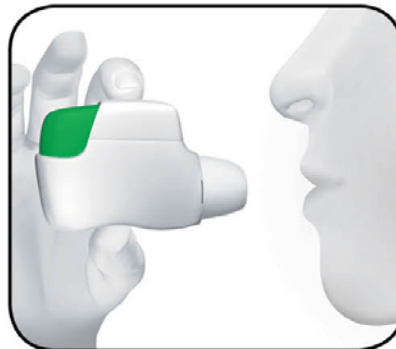

**Figure B**

- Look to see that nothing is blocking the mouthpiece.

**Step 2.** Hold the TUDORZA PRESSAIR inhaler with the mouthpiece facing you, but not inside your mouth. The green button should be facing straight up. **(See Figure C)**

**Hold with the green button facing straight up. Do not tilt.**



**Figure C**

**Step 3.** Before you put the inhaler into your mouth, **press** the green button all the way down. **(See Figure D)**

- Then **release** the green button. **(See Figure E)**
- **Do not continue to hold the green button down.**

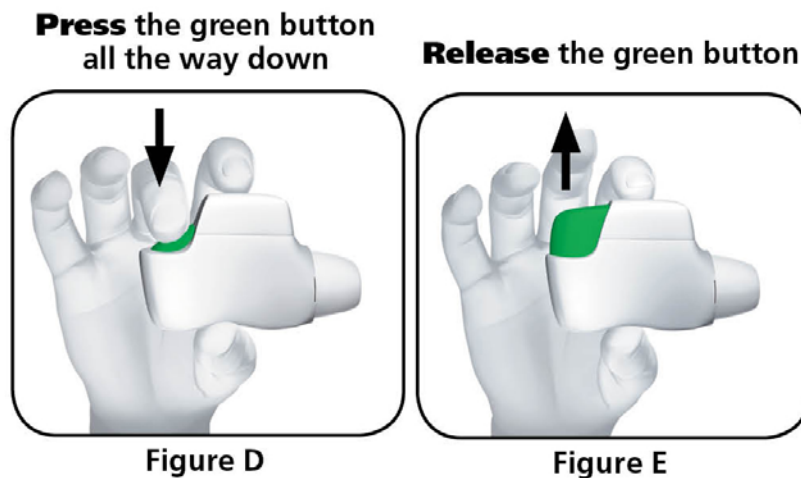

**Step 4. Stop and Check the Control Window to make sure your dose is ready for inhalation.** Look to see if the colored control window has changed from red (See Figure F), to green (See Figure G)

- The green control window tells you that your medicine is ready for inhalation. (See Figure G)

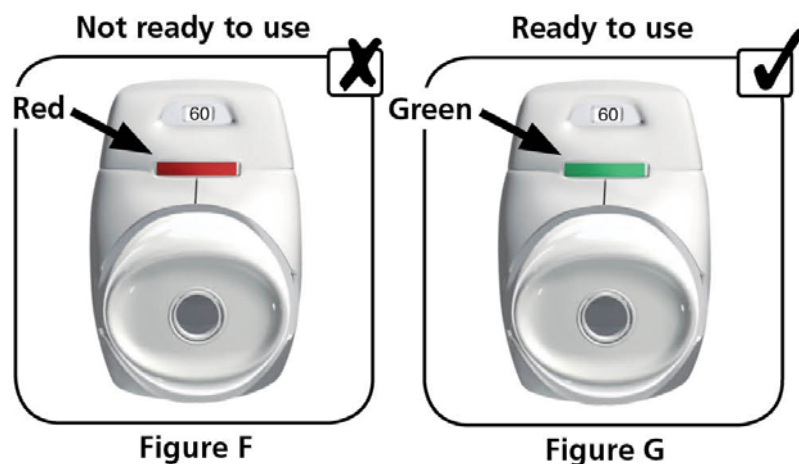

- If the control window stays red (See Figure F), repeat the Press and Release actions in Step 3 until the control window is green.

**Now the dose is ready to be inhaled.**

**Step 5.** Before you put the inhaler into your mouth, breathe out completely. Do not breathe out into the inhaler.

- Put your lips tightly around the mouthpiece of the TUDORZA PRESSAIR inhaler. Breathe in **quickly** and **deeply** through your mouth. (See Figure H). This quick,

deep breath makes sure that you get enough of the medication from the inhaler into your lungs.

- Breathe in until you hear a “**click**” sound. Keep breathing in, even after you have heard the inhaler “**click**” to be sure you get the full dose.

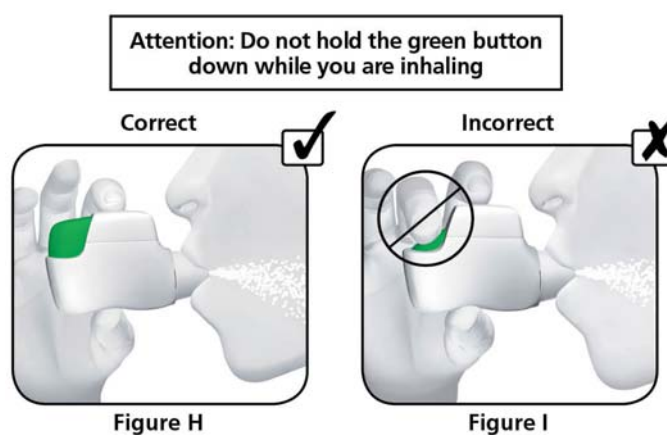

- Do not hold down the green button while you are breathing in. (See Figure I)

**Step 6.** Remove the TUDORZA PRESSAIR inhaler from your mouth and hold your breath for as long as is comfortable (See Figure J), then breathe out slowly through your nose.



Figure J

Some people may taste the medicine during their inhalation. Do not take an extra dose even if you do not taste anything after inhaling.

**Step 7. Stop and Check the Control Window. Make sure you have used your TUDORZA PRESSAIR inhaler correctly.**



- Look at the control window to see if it has turned to **red** (See **Figure K**) from **green** (See **Figure L**). If the window is **red** you have inhaled your full dose of medicine correctly.

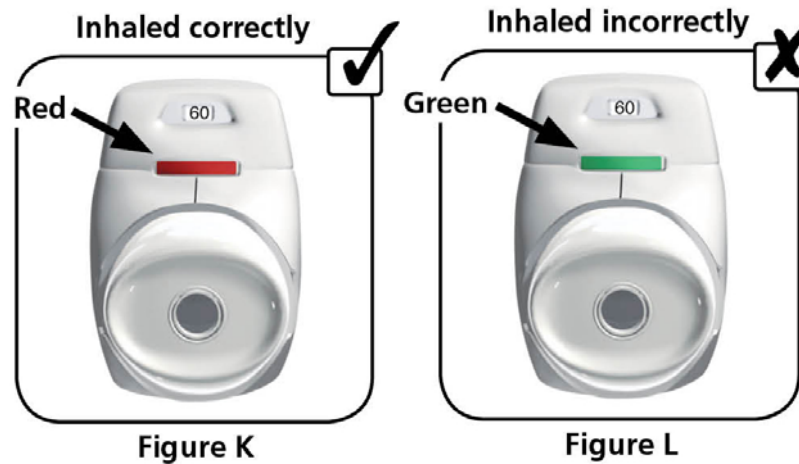

If the colored control window is still green, repeat **Step 5**.

- If the window still does not change to **red**, you may have forgotten to release the **green** button before inhaling or may not have inhaled correctly. If that happens repeat **Step 5** again.
- Make sure you have released the green button and take a **quick** and **deep** breath in through the mouthpiece.
- If you are unable to inhale correctly after several attempts, call your doctor.

**Step 8.** Once the window has turned **red**, place the protective cap back onto the inhaler by pressing it back onto the mouthpiece. (See **Figure M**)

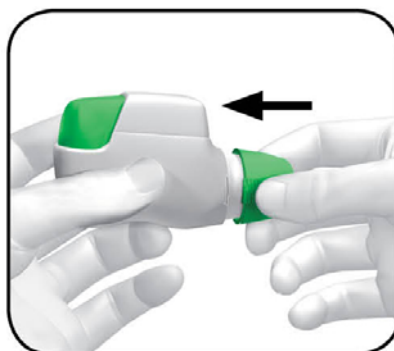

**Figure M**

## Additional information about the safe and effective use of TUDORZA PRESSAIR inhaler

### The “click” sound and colored control window:

- The “click” that you hear while inhaling tells you that you are using the TUDORZA PRESSAIR inhaler correctly.
- When you use the inhaler correctly the colored control window changes from **green** to **red**.
- Each time you are ready to use the TUDORZA PRESSAIR inhaler again, you will need to make sure the inhaler is ready by pressing and releasing the green button as seen in **Step 3**. When you press and release the green button the colored control window will change from **red** to **green**.

### When should you get a new TUDORZA PRESSAIR inhaler?

- The TUDORZA PRESSAIR inhaler has a dose indicator to show you how many doses are left in your inhaler. Each TUDORZA PRESSAIR inhaler has 60 doses of medicine.
  - When you start using the inhaler for the first time you will see the number **60** in the dose indicator.
  - You will see the number of doses count down in the dose indicator as you use the inhaler. The dose indicator moves down slowly, displaying intervals of 10 (60, 50, 40, 30, 20, 10, 0).
  - When a red band begins to appear in the dose indicator (**See Figure N**), this means you are nearing your last dose and should obtain a new PRESSAIR inhaler.

Dose indicator goes down by intervals of 10: 60, 50, 40, 30, 20, 10, 0.

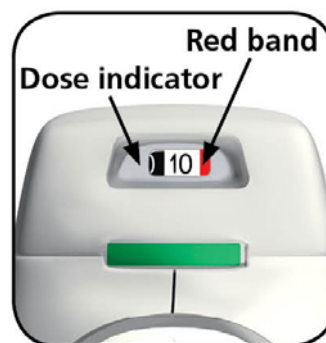

Figure N

- You should discard the inhaler and start a new one when
  - the marking “0” with the red background shows in the middle of the dose indicator (**See Figure O**), or
  - the device locks out (**See Figure P**), or
  - 45 days after you took the inhaler out of the sealed pouch, whichever comes first.



Figure O

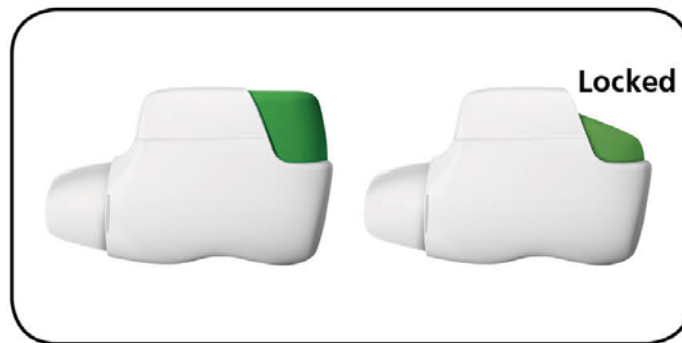

Figure P

- If your TUDORZA PRESSAIR inhaler appears to be damaged or if you lose the cap, your inhaler should be replaced.
- You **do not need** to clean your TUDORZA PRESSAIR inhaler. If you wish to clean it, wipe the outside of the mouthpiece with a dry tissue or paper towel. **Do not** use water to clean your TUDORZA PRESSAIR inhaler, as this may damage your medicine.

This Patient Information and Instructions for Use have been approved by the U.S. Food and Drug Administration.

Distributed by:  
Forest Pharmaceuticals, Inc.  
Subsidiary of Forest Laboratories, Inc.  
St. Louis, MO 63045



Under license of ALMIRALL



**TUDORZA** and **PRESSAIR** are trademarks of ALMIRALL.

Approved July 2012